

GuidePRO Band Saw Feed Guide



OWNERS MANUAL:

Bow Products GuidePRO Band Saw Feed Guide is designed primarily for use with Band Saws. This manual shows proper set up, use and adjustment procedures. Be sure to read instructions carefully. We highly recommend observing instructional videos on our website to understand set up and positioning: www.bow-products.com Be sure to read **TIPS** below. Also see GuidePRO accessories below.

⚠ WARNING: When using Electric Power Tools with the GuidePRO, Be sure to understand and adhere to the tool manufacturer's instructions including the safety precautions contained herein to avoid possibility of fire, Electric Shock or Personal injury. Read and understand all instructions before using this product. If you have concerns, confusion or questions, stop and call us Toll Free at: 844.895.4488

⚠ WARNING: When using the GuidePRO, be sure to adhere to the following general Safety guidelines. Failure to do so can result in serious injury or loss of limb or loss of life.

- Always ensure Power to the Band Saw is Shut Off until the GuidePRO and workpiece are set up, positioned clear of the cutting blade and are ready for in feed.
- Always ensure there is clearance for the workpiece to feed through the Blade.
- Once the GuidePRO is set, ALWAYS feed the workpiece with both hands on the workpiece, there is no need to hold the GuidePRO in place. ALWAYS finish the cut with Push Stick or pull the workpiece through from the opposite side of the blade. Keep your hands clear of the blade.
- If feeding multiple workpieces of similar material/dimension to make the same cut over and over, ALWAYS turn the Band Saw Power Off in between GuidePRO set up and feeds.
- When done with cut, ALWAYS turn the Band Saw off before removing the GuidePRO from the Miter Slot.

⚠ WARNING: California Prop 65: This Product may contain one or more chemicals known to the state of California to cause cancer and birth defects or other reproductive harm. For more information, go to www.P65warnings.ca.gov.

Familiarize yourself with the GuidePRO

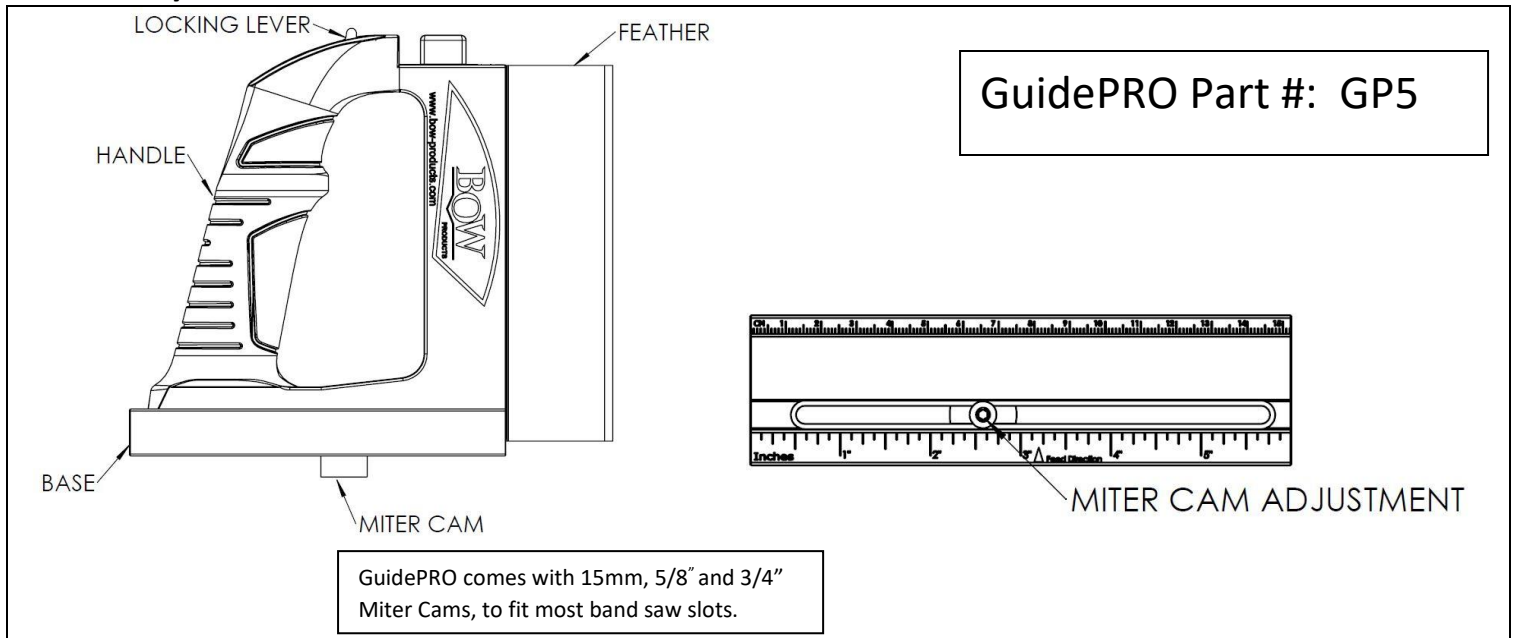

SET UP:  **WARNING:** Always ensure the Power Saw is turned off during set up.

IMPORTANT > PRACTICE SET UP SEVERAL TIMES BEFORE MAKING YOUR FIRST CUT:



Practice will help you get comfortable with set up, positioning and various pressure settings.

TIP: Watch videos for Set Up, Cutting and Tuning adjustments in GuidePRO section of website: www.bow-products.com

TIP: Rub fine saw dust all over the feather to make it easier to glide wood and to adjust or changeout to Extension feather.

- 1. Set Position of the Miter Cam on the GuidePRO Base:** The correct position enables you to push the GuidePRO Feather against the workpiece, apply pressure to the workpiece against the fence with the locking lever engaging. Using Allen Wrench provided, adjust the position of the Cam on the Base (Diagram 1 below). With the Cam loose, set the GuidePRO Base in the Miter Slot (diagram 2) to get an approximate position of the Cam on the Base. Push the GuidePRO Feather against the workpiece (Diagram 3) and check the Cam position, and then tighten with the Allen Wrench. The GuidePRO Handle has 5" (127mm) of slide range on the GuidePRO Base. You don't have to be exact in positioning the Miter Cam into the Miter Slot. GuidePRO comes with 15mm, 5/8" and 3/4" Miter Cams and works with Miter Slots that range from 2" - 8" (50mm – 203mm) from the blade. To understand the locking lever connection to the base as it relates to Miter Cam positioning on the base, see Locking Lever Adjustment below.
- 2. Setting the Workpiece, Fence and Band Saw Blade:** The GuidePRO base helps you do this. The GuidePRO Base is detachable and has measurements in metric and imperial that helps you measure the distance from the fence to the blade. Also use the base as a right-angle square to help you Square the fence to the table.
- 3. GuidePRO Positioning on the Workpiece:** Note that the GuidePRO Locking Lever must be in the open/up position (Diagram 3). Place the GuidePRO Miter Cam into the Miter Slot (diagram 2). The Miter Cam will slide inside the Miter Slot perpendicular to the workpiece and fence for initial positioning. Turn the GuidePRO clockwise until the Miter Cam comes to a stop in the Miter Slot (Diagram 4). Should be at a slight angle toward the blade. At this point, you want the workpiece approximately .5" to 1" away from the blade depending on your preference. You want the Feather approximately a 1/4" (6.5mm) back from the front edge of the workpiece. Then in one motion, with one hand pushing the workpiece and the other hand on the GuidePRO Handle (with your thumb up over the Locking Lever), simultaneously apply pressure and move the workpiece forward toward the blade. The Feather starts to flex depending on how much pressure you apply. When set, press down the Locking Lever to lock the GuidePRO in place (Diagram 5). The Objective is to end up with the workpiece near the blade (not touching) with the desired pressure, and the Feather approximately 1/4" back from the front of the workpiece. You are ready to start the cut.

Important Positioning Considerations:

-  **WARNING:** Always ensure the Power Saw is turned off during set up
 - The distance that the workpiece is from the blade once you set up is a matter of preference and safety consideration. Bow Products will NOT tell you exactly how close the workpiece should be next to the blade. Consult your Band Saws owner's manual.  **WARNING: DO NOT** have the GuidePRO or the workpiece in contact with the blade as you power up the Band Saw. Doing so can result in damage to your GuidePRO, your Band Saw and possibly severe injury to you. Many woodworkers keep the distance close to the blade (Approx. 1/4" (6.5mm)) to minimize chatter and get a cleaner cut all the way through the board.
 - The positioning of the GuidePRO Feather in relation to the workpiece. Our preference is to have the GuidePRO Feather Approx. 1.4" (6.5mm) back from the front edge of the workpiece.
- 4. Start the Cut:**  **WARNING:** Always finish the cut with a push stick. Once the GuidePRO is set up and locked into position, there is no need to hold the GuidePRO with your hand. Start the Band Saw and feed the material with both hands. Once the material passes through the GuidePRO, the GuidePRO will become loose in the miter track as it is no longer under pressure against the workpiece. Note the Locking Lever is still pressed down securing the Handle to Base. If you wanted to make similar repetitive cuts (same workpiece dimensions and same fence position, simply feed in the next workpiece and push it through the Feather (positioned in the same relationship to the blade). No need to reset the Feather pressure, leave the Lever Lock closed.

RECOMMENDATION: PRACTICE SET UP BEFORE YOU START CUTTING

GuidePRO Tool Adjustments:

GuidePRO Feather Positioning: The GuidePRO Feather should be close to or flush to the Band Saw table top. This ensures pressure of the Feather is applied along the workpiece from the bottom up. Also see our GuidePRO Extension Kit.

GuidePRO Locking Lever Adjustment:

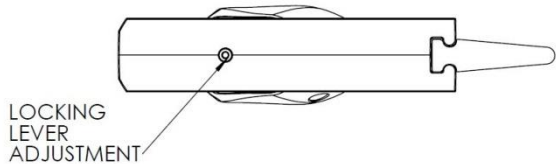

Turn the Lever Shaft counterclockwise to extend the shaft, clockwise to retract. Adjust only a quarter turn at a time.

As you press forward on the GuidePRO Locking Lever during set up, this secures the GuidePRO to the Base and locks in the pressure against the workpiece (refer to set up instruction above). The Locking Lever is attached to the Lever Shaft that extends down through the GuidePRO Handle assembly and extends out of the bottom of the GuidePRO. The distance that the Lever Shaft extends out of Base comes from the factory preset at 1/16" (1.6mm) and should not require adjustment.

To understand this important setting and when to make an adjustment, if the Lever Shaft sticks out to far, then the Lever Lock will not close all the way and you can't secure the GuidePRO handle to the Base. To fix, turn the Lever Shaft clockwise a quarter turn at a time until Lever Lock fully closes and secures the GuidePRO to the Base. Conversely, if the Lever Shaft were recessed too far into the GuidePRO, while the Lever Lock will close all the way, the Lever Shaft will not protrude enough to secure the GuidePRO to the Base, meaning the GuidePRO would slide on the Base and you could not hold Feather pressure against the workpiece. To fix, turn the Lever Shaft counterclockwise a quarter turn at a time until Lever Lock closes and secures the Handle to the Base. **CRITICAL SETTING:** The Adjustments to the Lever Shaft are very minimal. DO NOT unscrew (Counterclockwise) the Lever Shaft all the way out as you risk disconnecting the Lever Shaft from the Lever.

WARRANTY: GuidePRO comes with a One Year Limited warranty for Defects in Materials or Workmanship.

CUSTOMER SERVICE: You may contact us via customerservice@bow-products.com. You may also contact us at 844.895.4488.

GuidePRO ACCESSORIES:

- **GuidePRO EXTENSION KIT (Part # GP7):** Adds 4" extension (includes a 10" Feather). Ideal for taller panel feeds.
- **GuidePRO ANCHOR BAR (Part # GP9):** Replaces miter cam with locking miter bar. If you want to lock down the GuidePRO in a fixed position. Ideal for repetitive feeds. Anchor Bar needed to use GuidePRO on a Table Saw or Router.

Other Bow Products: FeatherDUO Featherboard; FeatherPRO, PushPRO Push Stick and Hardware Kits. See Website

REPLACEMENT PARTS: The only replaceable parts are the 6" silicon Feather(Part # 70014-01), and the miter cams. If needed, please call us at 844.895.4488, or use the contact form on our website.

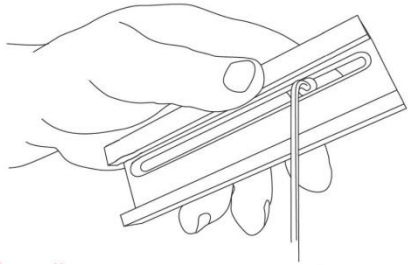

Diagram 1: Adjust position of Miter Cam in GuidePRO Base

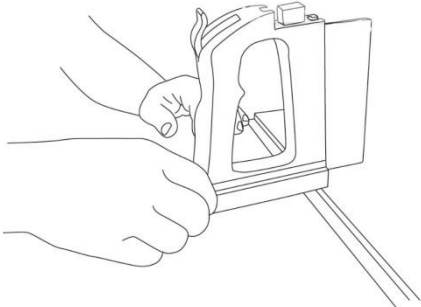

Diagram 2: Set GuidePRO Miter Cam in miter slot

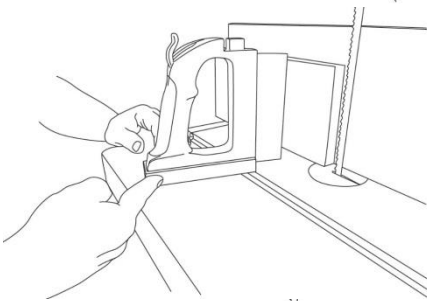

Diagram 3: Rotate GuidePRO clockwise until Miter Cam stops in the miter slot

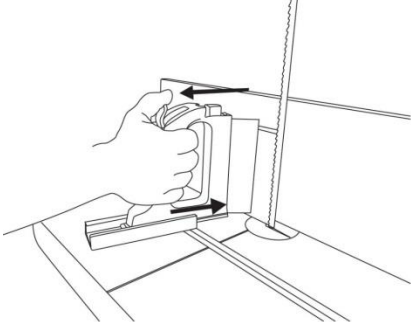

Diagram 4: With Locking Lever open, push GuidePRO Feather against workpiece with desired pressure while advancing workpiece toward the blade stopping approximately $\frac{1}{4}$ " short of blade. You want the Feather approximately a $\frac{1}{4}$ " (6.5mm) back from the front edge of the workpiece.

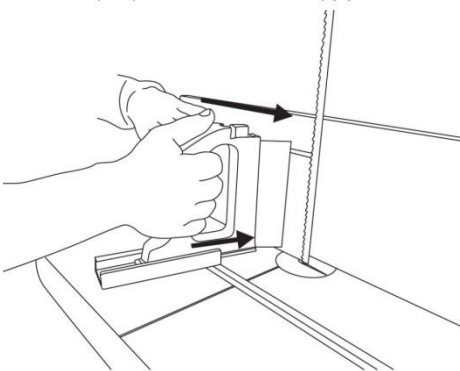

Diagram 5: Press down Locking Lever to hold pressure and position



Bow-Products
8778 Boyce Rd.
Corfu, NY 14036
844.895.4488
www.bow-products.com

GuidePRO Part #: GP5