

3 AXIS-ROUTER TABLE SL-660RT

MANUAL



Instructions

Maintenance

Assembly

(Router excluded)

Content

1. General Safety Rules For All Power Tools.....	3-5
2. Specifications.....	5
3. Assembly Table Stand.....	.6
4. Assembly Table with Stand.....	6
5. Assembly Router to Insert.....	6
6. Assembly Tenoning Jig to Sliding Bracket.....	7
7. Features & Operational Applications.....	7-8
8. Router Table Assembly Drawing.....	9
9. Part List.....	10-12
10. Stand Assembly Drawing.....	13
11. Statement Of Conformity.....	N/A

1. General Safety Rules For All Power Tools

1.1 READ carefully and thoroughly **AND BE FAMILIAR** with the owner operating manual. Learn its limitations and applications and potential hazards.

1.2 ALWAYS KEEP THE GUARD in place and in proper working condition.

1.3 GROUND ALL TOOLS. If the tool is equipped with a three pronged plug, it should always be plugged into a three-hole electrical receptacle. If an adapter is used for a two-pronged receptacle, the adapter's lug must be connected to a known ground cord and **NEVER** remove the third prong.

1.4 CHECK DAMAGED PARTS. Before further using the tool, any damaged parts should be checked to assure that it will perform and operate properly for its intended purposes. Replace and align all moving parts, mounting, or any other conditions that may affect its operation.

1.5 REMOVE ALL ADJUSTING KEY AND WRENCHES. –Always form the habit of checking that all keys and adjusting wrenches are removed from the tool before starting operation.

1.6 DISCONNECT UNIT BEFORE SERVICING and when changing blades, bits or cutters to avoid accidental starting.

1.7 KEEP WORKING AREA CLEAN. –Cluttered areas and benches can cause accidents. Don't use the unit in damp or wet locations or expose it to the rain. Also keep the working area well and properly lighted.

1.8 USE SAFETY GLASS AND WEAR PROPER APPAREL –Also use face or dust mask if the operation is dusty. Wearing loose clothing or jewelry is not desirable because it may get caught in moving parts. Put on protecting hair covering to contain long hair.

1.9 KEEP CHILDREN AND VISITIORS AWAY. –All visitors should be kept

at a safe distance away from the working area, especially while operating tools.

1.10 MAKE WORKSHOP SAFE PROOF. Lock tools when not in use by removing starter keys or the master switches.

1.11 DON'T FORCE THE TOOL. –It will perform a better and safer job at a rate for which it was designed. Allow the motor to reach full speed before cutting.

1.12 USE RIGHT AND PROPER TOOL. –Don't use any other tool attachment to do a job which is not designed for it.

1.13 USE RECOMMENDED ACCESSORIES. –Consult the owner manual for all recommended accessories. Improper use of the tools may cause accidents.

1.14 MAINTAIN TOOLS IN TIP. –TOP CONDITION. –For safest performance keep the unit clean. Follow all instruction of lubrication and changing attachment or accessories.

1.15 DON'T EVER OVER REACE. –Keep proper footing and balance of your body at all time during operation of tools.

1.16 SEVURE WORK PROPERLY. –Use vises or clamps to hold work. It is practical and much safer than using your bare hand.

1.17 NEVER LEAVE THE TOOL UNATTENDED. –Turn the switch in OFF position and don' leave unit until it has completely stopped.

1.18 NEVER STAND ON THE TOOL. –Serious injury could occur if the unit is tipped or if the blade is accidentally contacted.

1.19 DIRECTION OF FEED. –Always feed the work piece into the blade against the rotation of blade or cutters.

1.20 DRUGS, ALCOHOL AND MEDICATION. –Never operate tools while under influence of drugs, alcohol. Or after taking medication.

1.21 NEVER ATTEMPT to perform an abnormal operation. Don't try to cut small pieces. Always use adequate hold-down/pushback, jigs, or fixtures...etc.

1.22 Please always use only the supplied cord with plug for our power tools, which rated current and the rated power input.

1.23 Proper fuse is required for supply & replacement.

****Note: Always KEEP THE MANUAL AND REVIEW IT FROM TIME TO TIME. REVIEWING THE MANUFAL AND FOLLOWING THE INSTRUCTION WILL GIVE YOU A CONTIOUS SAFE & PROPER OPERATION.**

3-AXIS ROUTER TABLE

SPECIFICATIONS

Model/Item No : SL-660RT
Table Sizes : 26" X 18.5" (665mmX 475mm)
Table Inserts : 11.8" X 9" (300mm X 230mm)
Table Height : 32.3" (320mm)
Table Thickness : 1.5" (38mm)
Table T-Slot : 3/8" X 3/4" (9.5mm X 19mm)
Fence Size : 26.4" X 4.75" (660mm X 121mm)
Dust Hood : 4" (101mm)
Net Weight : 64 KGS
Gross Weight : 68 KGS
Packing Dimension : 35" X 29.13" X 10.23"

1. UNPACKAGING CARTON PACKAGE – Please carefully unpack carton & check all loosed parts are in order per part lists.

2. ASSEMBLY TABLE STAND – Please refer to picture right for complete table stand assembly.



3. ASSEMBLY TABLE TOP WITH STAND ASSEMBLY– Fasten 4 table bottom corners by screws with stand.



(4 screw holes in back of table top)



(Complete setup)

4. ASSEMBLY ROUTER TO TABLE INSERT

4.1 Remove insert by unfastened 4 screws on insert top, below Left.

4.2 Attach & secure router ring edge (using sketch router instead on picture) on 4 clamp pieces by tightened 4 wing nuts, check sketch picture below Right.

4.3 Table inserts & clamps are applicable for various sizes or brands of routers. Fitting various motor specifications range from 3/4HP up to 5HP motor.

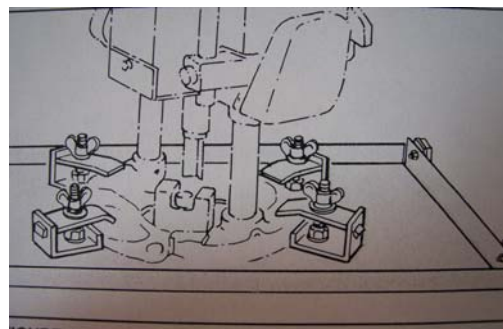
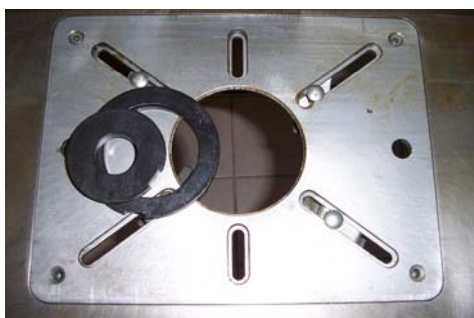

Left – 4 screws in 4 corners

Right – please note router edge & clamp

5. ASSEMBLY TENONING JIG / BRACKET TO SLIDING

BRACKET – Fasten tightly lock bar to tenoning bracket and then attach to sliding bracket. Be sure to put bearing on trail of fence top.

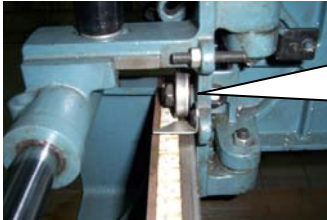

Be sure bearing on trail of fence top.

Very easy design to install, setup or remove for other operational applications

6. SPECIAL FEATURES AND OPERATIONAL APPLICATIONS

6.1 Fence can move back and forth, traveling 204mm (8 inches) to rear fence & 230mm to front table edge.

204mm (8 inch) to rear fence

230mm (9 inch) to table edge

(Measuring scale on right side of table edge)



6.2 Design of tenoning jig for working vertically or horizontally.

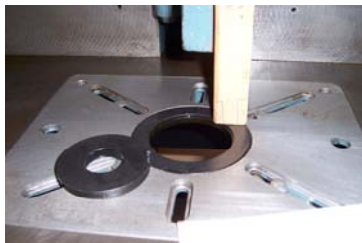

6.3. Tenoning jig axial slide with fence back and forth moving can work for dovetail tenoning and various tenoning grooves and heads.

(Actual application examples in pictures for reference.)



(Vertical operation with tenoning jig)

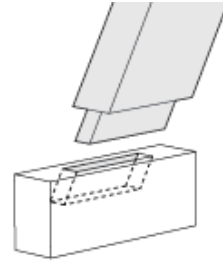

(More other vertical operation with tenoning jig)



(Horizontal operation with miter gauge & anti-kick back kit)

6.4 All cast iron table and fence with sturdy construction and 4 inch dust hood for conveniently and easily connected with dust collector.



(All cast iron table & fence)



(4 inch dust hood)

6.5 Other special applications of pressure device kit



(**Bearing end** for shaping application)



(Pressure block & anti-kick back kit)

7. ROUTER TABLE ASSEMBLY DRAWING

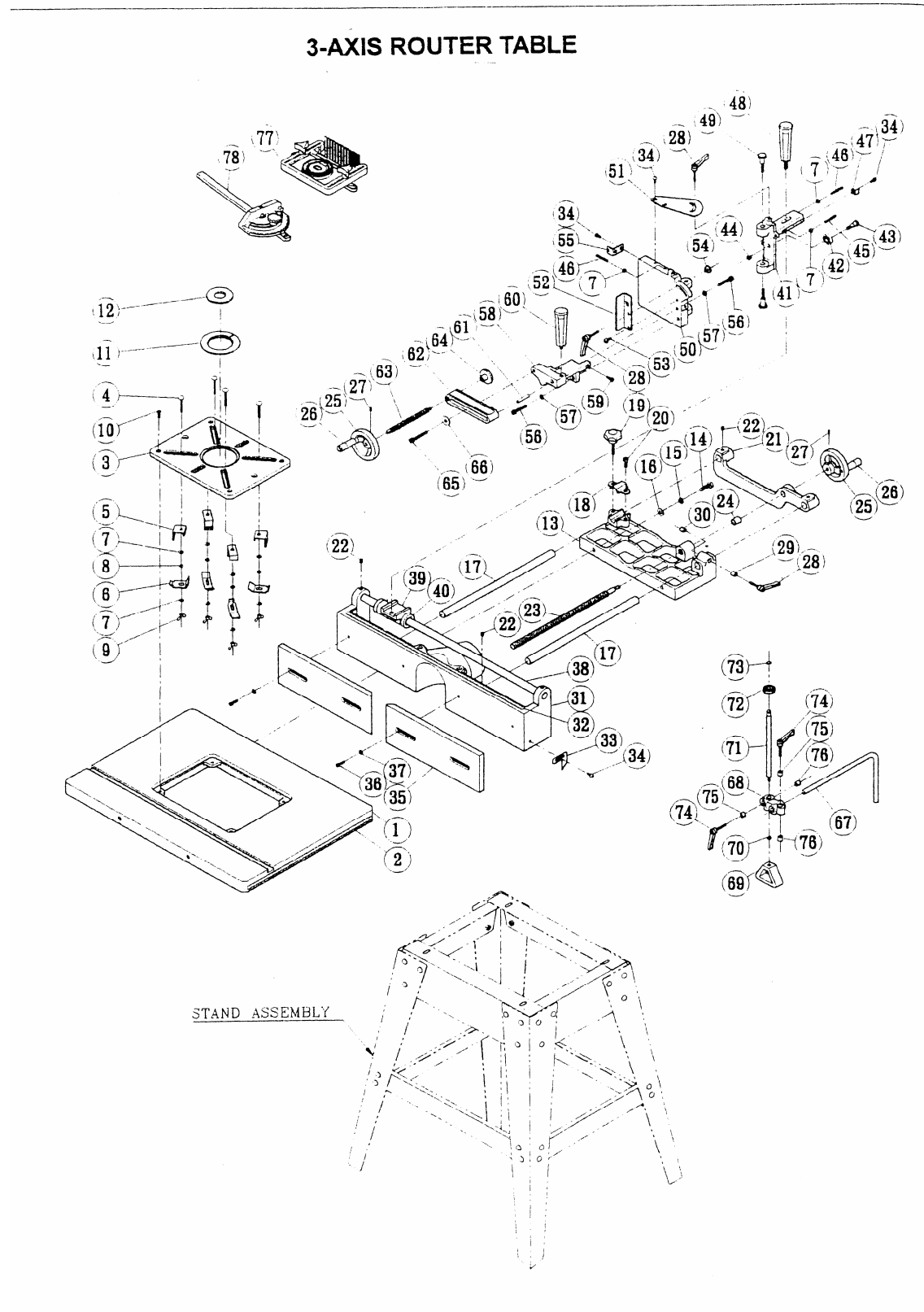

8. Parts List

PART NO.	DESCRIPTION	Q'TY
RT660001	TABLE	1
RT660002	SCALE	1
RT660003	TABLE INSERT	1
RT660004	CARRIAGE BOLT M6×45	4
RT660005	CLAMP PIECES(UPPER)	4
RT660006	CLAMP PIECES (LOWER)	4
RT660007	FLAT WASHER M6×φ19	8
RT660008	NUT M6	7
RT660009	WING NUT M6	4
RT660010	COUNTERSUNK HEAD SCREW M6×20	4
RT660011	GUARD PIECES (A)	1
RT660012	GUARD PIECES (B)	1
RT660013	EXTENSION WING	1
RT660014	HEX HEAD SCREW M	2
RT660015	LOCK WASHER M10	2
RT660016	FLAT WASHER M10×φ27	2
RT660017	SLIDING ROD	2
RT660018	LOCATED PIECES	1
RT660019	LOCK KNOB M8×25	1
RT660020	HEX. SOCKET CAP SCREW M8×25	1
RT660021	ADJUSTED BRACKET	1
RT660022	SET SCREW M8×10	6
RT660023	FEED ROD	1
RT660024	BUSHING	1
RT660025	HAND WHEEL (塑膠)	2
RT660026	HANDLE	2
RT660027	SET SCREW M6×10	2
RT660028	LOCK HANDLE	
RT660029	CATCH NUT	
RT660030	CATCH NUT	2
RT660031	FENCE	1
RT660032	SCALE	1

PART NO.	DESCRIPTION	Q'TY
RT660033	POINTER	1
RT660034	PAN HEAD SCREW M6×12	6
RT660035	GUARD PLATE	2
RT660036	HEX. SOCKET CAP SCREW M6×25	4
RT660037	FLAT WASHER M6×φ13	4
RT660038	SLIDING ROD	1
RT660039	SLIDING BRACKET	1
RT660040	BUSHING	2
RT660041	TURNING BRACKET	1
RT660042	BALL BEARING 6200ZZ	1
RT660043	ADJUSTED SCREW	1
RT660044	NUT M8	1
RT660045	SET SCREW M6×25	1
RT660046	SET SCREW M6×40	2
RT660047	POINTER	1
RT660048	LOCK BAR	1
RT660049	STUD	2
RT660050	WORKING TABLE	1
RT660051	ANGULAR SET PLATE	1
RT660052	BASE PLATE	1
RT660053	LOCATED SCREW	1
RT660054	LOCATED NUT	1
RT660055	BASE PIECES	1
RT660056	HEX. SOCKET CAP SCREW M8×40	2
RT660057	LOCK WASHER M8	2
RT660058	SUPPORT BRACKET	1
RT660059	HEX. SOCKET CAP SCREW M6×20	1
RT660060	LOCK BAR	1
RT660061	SPRING PIN φ 10×50	1
RT660062	ADJUSTED BLOCK	1
RT660063	FEED STUD	1
RT660064	CLAMP DISC / BAND	1
RT660065	HEX. SOCKET CAP SCREW M8×40	1
RT660066	FLAT WASHER M8 ×φ 30	1
RT660067	GUIDE BAR	1

PART NO.	DESCRIPTION	Q'TY
RT660068	PRESSURE BLOCK BRACKET	1
RT660069	PRESSURE BLOCK	1
RT660070	NUT M8	1
RT660071	PRESSURE SHAFT	1
RT660072	BALL BEARING 6200ZZ	1
RT660073	RETAINING RING S10	1
RT660074	LOCK HANDLE	2
RT660075	CATCH BIT	2
RT660076	CATCH NUT	2
RT660077	ANTI-KICK BACK KIT	1
RT660078	MITER GAUGE	1

9. Stand Assembly Drawing

